



## Technical data sheet

# EOSphere

## The event heater with plunging steam-shock effect for commercial sauna cabins.

The innovative event heater will turn your sauna visit to a unique experience. Impressive design with a movable rock store and an underlying illuminated water tank makes the EOSphere a highlight in every sauna.

The heat output of the EOSphere alone is not sufficient for a sauna and usually requires an additional heating system.

### Your advantages:

- Spectacular steam-shock effect with accompanying colour and light effects thanks to the innovative plunging function: The separate rock store heats the stones and then plunges down into the underlying water tank, accompanied by the specially coordinated light effects with colour changes from red to blue.
- High-quality construction, carefully crafted down to the last detail, with a high-contrast design of polished stainless steel and powder-coated components with anthracite pearl effect.
- Fully automatic function with adjustable time intervals and dwell time of the rock store in the water tank. Manual or automatic start.
- Luxury and exclusivity - no mass production, each system is individually handcrafted. Made in Germany quality from EOS.

### Specifications:

Outer shell:	Stainless steel
Rock store:	Stainless steel
Power input:	3,5 kW
Power supply:	400 V 3N AC 50 Hz
Stone filling:	approx. 45 kg (Stones optionally available)
Dimensions (HxWxD):	158 x 72 x 98 cm
Installation:	Floor-standing model

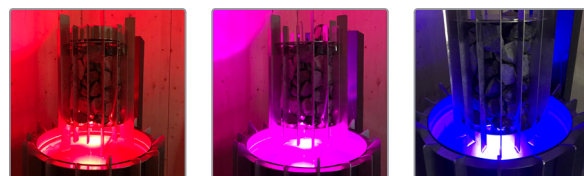

Example of varying colours in the water tank due to the temperature changes

**CE EAC IPx4** MADE IN GERMANY

## Connection overview

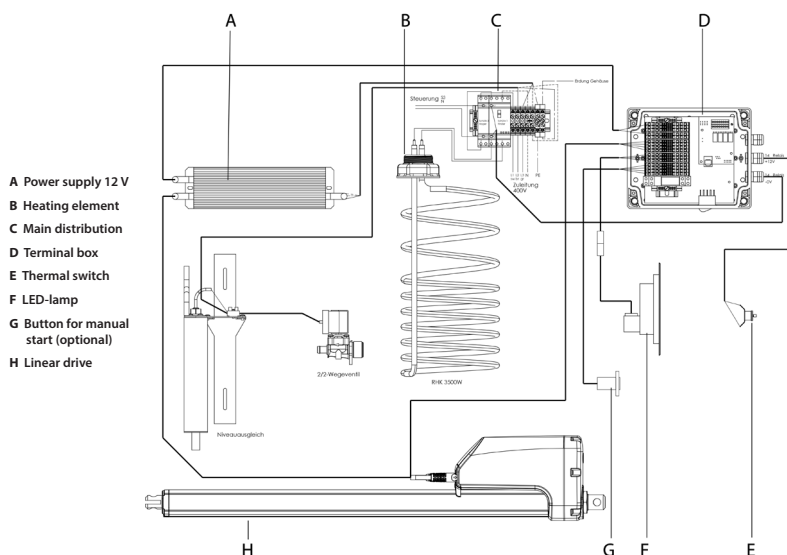

## Installation example

EOSphere must be aligned vertically and horizontally.  
To level out a sloping floor, a platform may have to be built.

**!** Separate safety temperature limiter (STB) above rock store required.

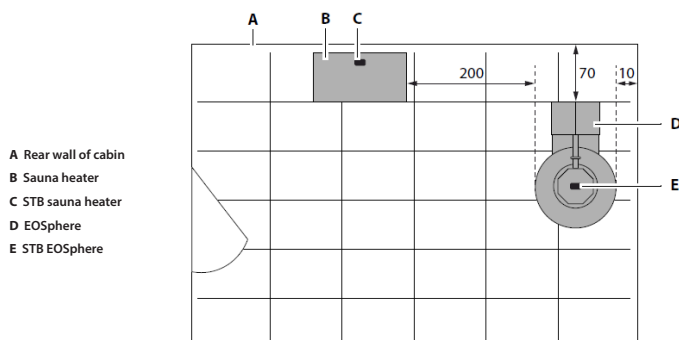

**!** Approx. 10 cm distance to side of the wall  
Approx. 70 cm distance to rear wall  
Approx. 200 cm distance to heating sauna heater

## Minimum clearances

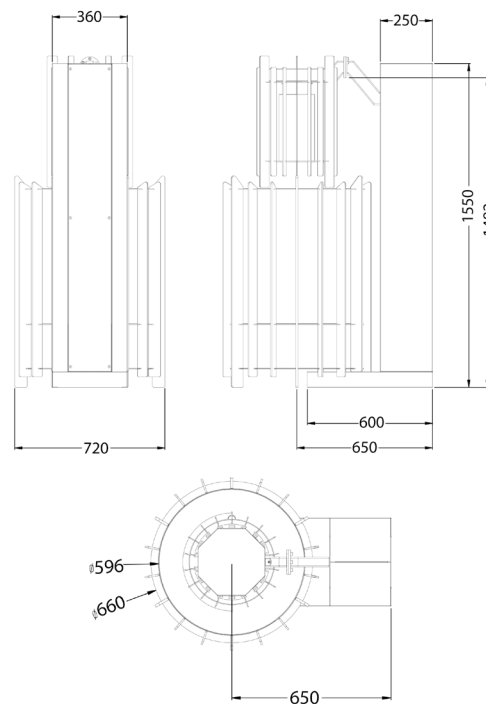

## Suitable sauna control units

Model	Item no.
EOS Econ D2	94.6138
EOS Econ D3	94.6140
EOS Econ D4	94.5842
EOS EmoTec D	94.5559
EOS EmoStyle D	94.6316
EOS EmoStyle Hi	94.6317
EOS EmoTouch 3	94.6505

## Optional accessories

Button for manual operation	94.7380
-----------------------------	---------

## Technical specifications

Item no.	Power input	Electrical connection	Fuse protection control unit	Fuse protection LSG unit	Dimensions H/W/D, in cm	For sauna cabin size	Min. ceiling height	Weight without rocks	Stone filling	Power extension required
94.7040	3,5 kW	400 V 3N AC 50 Hz	3 x 16 A	3 x 16 A	158 / 72 / 98	~60 m <sup>3</sup>	2,1 m	185 kg	~45 kg	no